

USE & MAINTENANCE:

Collect

Start-up: Turn the diverter control handle on the rain valve to the “collect” position, so the rainwater from the roof enters the barrel. Close the drain at the base of the barrel. The faucet, with a 3/4-inch hose thread, can be used to fill watering cans or to connect a hose for lawn watering or drip irrigation systems.

Monthly: Clean your filter bag every month. Pull the diverter drum out of the rain valve. Turn the Nitex filter bag inside out and spray with a hose to remove any debris that has collected. Replace the diverter drum.



Remember – after a rain, it's time to drain!

An empty rain barrel is ready to keep more rainwater out of our storm drains and sewers the next time it rains.

Bypass

Shutdown: Just prior to freeze-up, drain the barrel and leave the valve open. Turn the diverter control handle on the rain valve to the “bypass” position so that the rainwater from the roof bypasses the barrel and flows directly onto a porous surface.



Warning: Water collected from the roof is not sanitary for consumption. The manufacturer assumes no responsibility for failure due to improper installation or assembly.

RiverSides works with communities across North America to protect urban rivers. We are recognized as the leading nonprofit organization addressing nonpoint-source pollution prevention.

For additional information, please contact RiverSides:

Web: www.riversides.org

E-mail: rainbarrels@riversides.org

Phone: 416.868.1983

Follow & Like Us on **Twitter** (@RiverSafe) and

Facebook (The RiverSafe RainBarrel Fan Page)



RiverSafe RainBarrel Installation and Operation Guide

Thank you for purchasing the RiverSafe® RainBarrel

This custom-designed rain barrel works day in, day out, to **protect streams and rivers** by keeping roof runoff out of storm drains and sewers, and letting it flow into the ground to replenish the groundwater table. Its **generous 500 L/132 gallon capacity** means that every household can contribute to healthy rivers, conserve potable water, and help reduce the impacts of climate change in our communities.

The RiverSafe RainBarrel is secure and safe to use. Its tough, solid, one-piece construction is designed to provide a **lifetime of worry-free use**. Each barrel is made of UV-stabilized LLDPE to prevent warping, fading or cracks, and has a **unique filter system**. The 200-micron mesh filter makes your RiverSafe RainBarrel mosquito-proof, and stops sediment and other fine particles.

The RiverSafe RainBarrel provides **easy seasonal operation**. (See Maintenance Instructions on the back cover.) Winter or summer, operating your rain barrel is as easy as a simple turn of our **unique diverter system**.



The path to clean water begins in your own backyard. With every RiverSafe RainBarrel installed, we all make a positive difference.



COMPONENTS & ASSEMBLY:

It's easy to assemble your RiverSafe RainBarrel. Ensure that your barrel has all the following parts. Attach the diverter system as illustrated and install the downspout as directed below. Downspout pipe and elbows are not included.

Your RainBarrel kit includes the following:

- 1 500 L/132 gal. capacity rain barrel
- 2 Rainwater diverter system
- 3 ¾-inch brass mini-ball valve with ¾-inch hose thread
- 4 ¾-inch HDPE drain plug
- 5 Diverter housing
- 6 Diverter valve and control handle
- 7 ¼-inch foam gasket for sealing the diverter to the barrel
- 8 4 – ¼-inch bolts to connect the diverter housing to the barrel
- 9 1x4x10-inch, 200 micron Nitex mesh filter

Brass mini-ball valve and drain plug

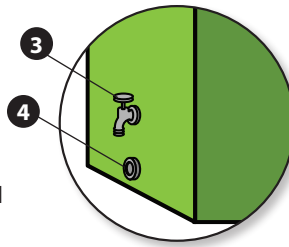

RainBarrel

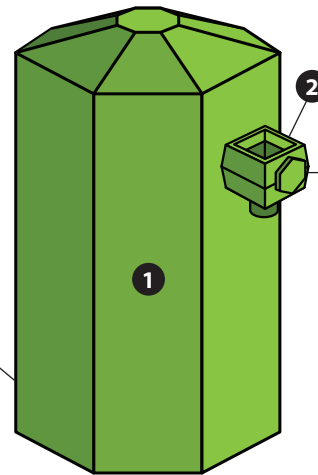

Rainwater diverter system

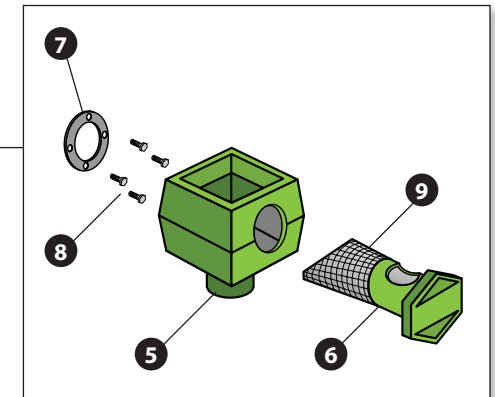

INSTALLATION:

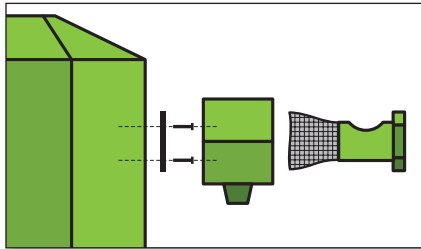

Step 1: Assemble your rain barrel

1. Separate the diverter valve from the diverter housing.
2. Place the foam gasket on the diverter housing.
3. Use one bolt at a time to secure the gasket and diverter housing to the barrel.
4. Tighten bolts snugly.
5. Ensure that the 200-micron Nitex-mesh filter sock is securely attached and insert the cylinder inside the diverter housing.
6. The drain holes are located near the bottom of the barrel directly opposite the diverter system. Attach the brass mini-ball valve and drain plug into either the top or the bottom threaded fittings as desired to match your water-use preferences.

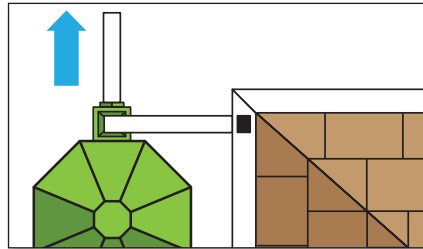

Step 2: Select a suitable site

1. Locate the downspout (roof drain) on your home that is the most convenient location for the placement of the RainBarrel.
2. Ensure that the rain barrel sits on a level and compacted surface. A concrete pad or paver can be used for additional stability.
3. Place the rain barrel flat on the base. Position with the rain valve closest to the downspout. Ensure the filter can be removed for regular cleaning.
4. Ensure the brass valve is easily accessible for filling watering cans, attaching hoses, etc.

Ensure proper threading. Do not over-tighten. Warranty is void if screws are cross-threaded or misapplied.

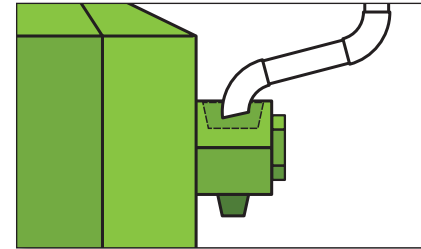

Step 3: Connect Downspout to RainBarrel

1. Cut the downspout on your house approximately 12 inches above the top of the rain valve intake trough.
2. If the downspout was connected to the sewer, be sure to cap it properly.
3. Retain the cut-off section of downspout for the bypass flow at the bottom of the diverter valve.
4. Install a new section of downspout pipe (not included) with an elbow attached to the diverter system intake trough. A hinged diverter elbow may provide an easier installation and maintain the slope angle required for good flow.

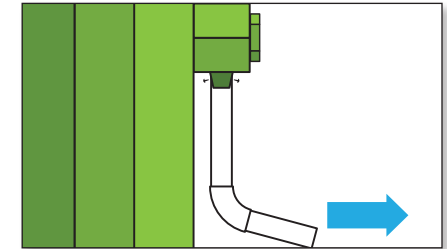

Step 4: Connect Rain System Bypass

1. Connect the overflow/bypass pipe to the bottom of the diverter system using two or more ½-inch self-tapping screws (not included).
2. Attach a diverter elbow and a section of horizontal pipe to carry the overflow/bypass water to a permeable drainage area at least 4 feet away from the house foundation. It is recommended that you add an optional diffuser to the discharge point of the overflow/bypass pipe to prevent erosion.
3. Your rain barrel is now ready to use. See back page for use and maintenance instructions

